

CREEKSIDE DRIVE

DRIVE

FOUR MILE CREEK ROAD (FORMERLY KING'S HWY. No. 9)
 (TRANSFERRED TO BE READY BY ORDER OF COUNCIL OF THE TOWN OF NIAGARA-ON-THE-LAKE ON 02/25/2010 BEING HWY. PLAN 835-1-1227-10)
 (LOCALLY KNOWN AS) REGIONAL ROAD No. 100
 (REFERENCED BEHIND) HWY. PLAN 411

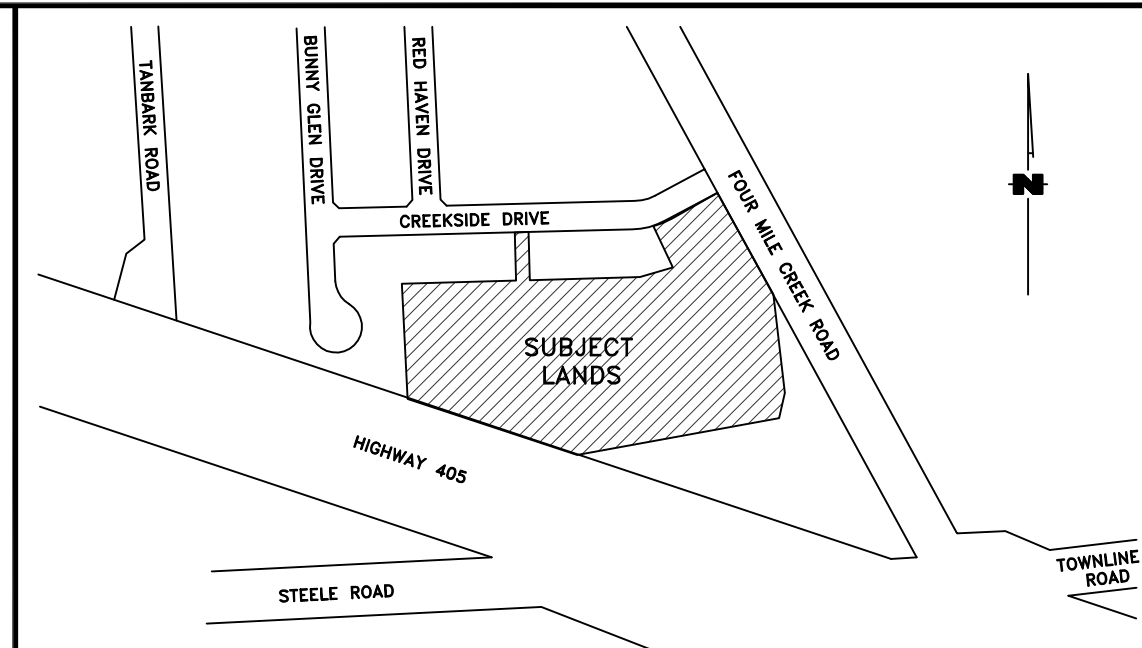

KEY PLAN
 Town of Niagara-On-The-Lake
 (not to scale)

PLAN TO ILLUSTRATE PROPOSED AREAS AND SETBACKS FOR BY-LAW PURPOSES OF
BLOCK 27, PLAN 30M-384
 AND
PART OF NIAGARA TOWNSHIP LOT 92
TOWN OF NIAGARA-ON-THE-LAKE
 REGIONAL MUNICIPALITY OF NIAGARA

SCALE 1 : 400
 Matthews, Cameron, Heywood - Kerry T. Howe SURVEYING LIMITED
 LLN: 58948
 2010

- ⊙ DENOTES AREAS FOR CONCERN REGARDING COMPLIANCE WITH EXISTING BY-LAW
- ① MINIMUM FRONT YARD SETBACK OF DWELLING UNIT FROM PRIVATE ROAD.....4.0m(13.12 ft.)
 - ② MINIMUM FRONT YARD SETBACK OF GARAGE FROM UNIT LINE.....3.0m(9.84 ft.)
 - ③ MINIMUM FRONT YARD SETBACK OF GARAGE FROM PRIVATE ROAD.....6.0m(19.68 ft.)

SITE INFORMATION

NUMBER OF UNITS	59 TOWNHOMES
TOTAL AREA OF SITE	33521.8 sq.m. (3.35 Ha.)
UNITS PER HECTARE	17.61
BUILDING AREA	9830.2 sq.m.
BUILDING COVERAGE	(29.32%)
LANDSCAPED OPEN SPACE	16723.7 sq.m. (49.9%)
AREA OF ROADWAY	4581.9 sq.m.
AREA OF VISITOR PARKING	566.8 sq.m.
AREA OF DRIVEWAYS	1819.2 sq.m.
	TOTAL=6967.9 sq.m. (20.78%)
PARKING	104 GARAGE SPACES 104 DRIVEWAY SPACES 32 VISITOR SPACES TOTAL=240 SPACES

MATTHEWS, CAMERON, HEYWOOD - KERRY T. HOWE SURVEYING LTD.
 5233 Stanley Avenue - Unit #1, Niagara Falls, Ontario L2E 3Z2 Phone 358-3663 Fax 358-6224
 98 Church Street, St. Catharines, Ontario L2R 3Z8 Phone 627-3300
 www.thesurveyors.ca